

HYPHERPRO

STEERING DAMPER MOUNTING KIT

for
DUCATI 848
Models 2008 >

MK-DU08-T001 PART LIST

SD stroke 75	1	Washer M6 ϕ 12	2
Tube Clamp TYPE 10	1	Washer M8 ϕ 16	2
O-Ring	2	Spacer D14 d8.2 L20	1
Fork Clamp ϕ 53	1	Nut M6 long - modified	2
Tank bracket (TAMK61)	1	-	-
M6x16	2	-	-
M8x25 Button head	1	-	-
M8x45 Button head	1	-	-

ALL IDEAS, DESIGNS, ARRANGEMENTS AND PLANS INDICATED OR REPRESENTED BY THIS DRAWING ARE OWNED BY HYPERPRO AND WERE CREATED, EVOLVED AND DEVELOPED FOR USE ON AND IN CONNECTION WITH THE SPECIFIC PROJECT. NONE SUCH IDEAS, DESIGNS, ARRANGEMENTS OR PLANS SHALL BE USED BY OR DISCLOSED TO ANY PERSON, FIRM OR CORPORATION FOR ANY PURPOSE WHATSOEVER WITHOUT THE WRITTEN PERMISSION OF HYPERPRO.

DAMPING ADJUSTER KNOB:
- turn CW to increase damping
- turn CCW to decrease damping
NEVER USE MAXIMUM SETTING !!!

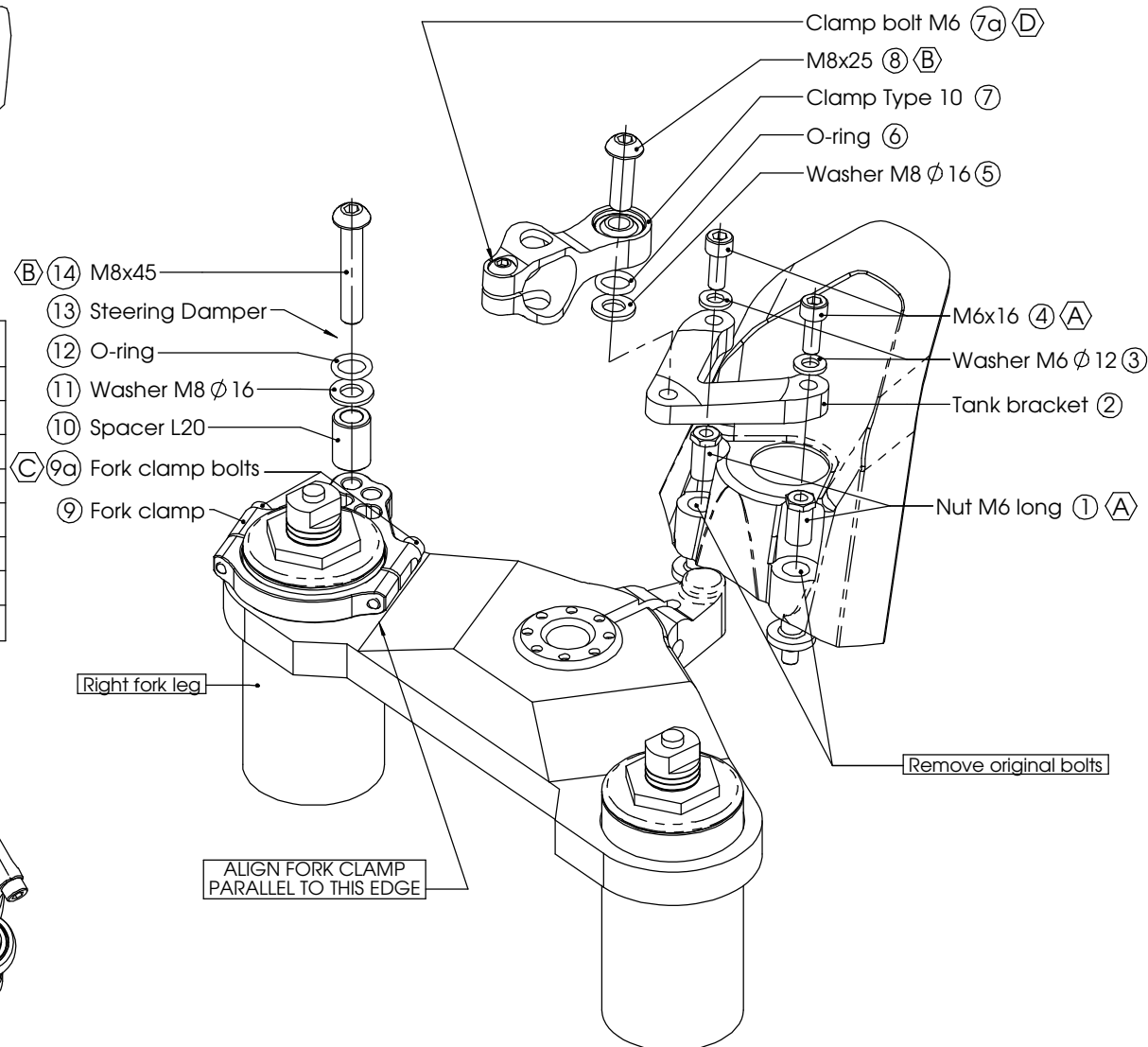
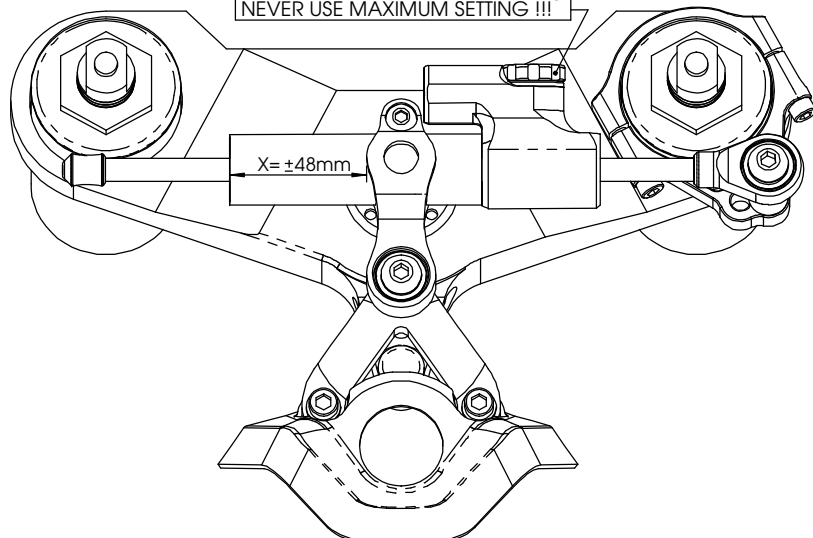

1
of 2

(A) 5-9Nm / 44-80Lbs.In / 4.0-6.4Lbs.Ft	(C) 8Nm / 70Lbs.In / 5.9Lbs.Ft
(B) 14-17Nm / 124-150Lbs.In / 10.3-12.5Lbs.Ft	(D) 6Nm / 53Lbs.In / 4.4Lbs.Ft

See WWW.HYPERPRO.COM for the latest pictures, modifications, specs. and e-drawings of this steering damper kit.

HYPHERPRO

STEERING DAMPER MOUNTING KIT

for

**DUCATI 848
Models 2008 >**

MK-DU08-T001 INSTALLATION INSTRUCTIONS

In general:

HYPHERPRO can not be held responsible in any way for any form of physical, material, financial or other damage arising from use, assembly or overhaul of HYPHERPRO products. HYPHERPRO reserves the right to make changes without prior notice.

This product is ONLY TO BE INSTALLED BY A PROFESSIONAL MECHANIC.

This product is only to be used for the motorcycle brand, model and year stated specifically on top of the pages of this manual.

DO NOT attempt to install this product on motorcycles from any different brand, model and/or year than stated on the pages of this manual.

DO NOT use this kit for cars, boats, jet-skies, snowmobiles, ATV's, aircraft, hovercrafts or any other vehicle and/or purpose.

HYPHERPRO steering dampers are FOR RACE USE ONLY, NOT FOR HIGHWAY USE!

Before installation:

- Please read the entire manual carefully before starting the installation!
- Check if you have all the tools required. Good tools are a must.
- Protect your bike at the most important places in and around the work area (e.g. tank, fairing, frame, etc.) with a blanket, towel or similar.

During installation:

- Check all operations and parts carefully before, during and after performing each step.
- Clean all surfaces that are required for fitting parts together or for applying self adhesives or loctite, thoroughly with contact cleaner or another degreaser, unless otherwise stated.
- Be careful not to damage or scratch any part of your bike.
- ALWAYS work relaxed and concentrated!! It is very easy to damage something or make a mistake.

After installation:

- Check and make sure that there is no contact between any part of the steering damper kit and any part of the motorcycle. The kit should not hit anything. Steering movement should not be limited by the steering damper. If the steering movement is limited, adjust the position of the tube in the clamp until steering movement is normal again. Do not forget to tighten the clamp bolt again!
- ALWAYS check the steering movement and feeling before each ride!
- FIRST RIDES: Start with the damper turned fully open (turn adjuster knob fully counter clockwise). Start adjusting in between rides with steps of MAX. 2 CLICKS (0.25 TURN) EACH TIME, until the damper is working satisfactory for your riding style.
- NEVER USE MAXIMUM SETTING, ALWAYS OPEN AT LEAST 2 CLICKS (0.25 TURN).

- WARNING ! DAMPER HAS AN ACTIVE / SPEEDSENSITIVE DAMPING SYSTEM;
 - Steering with NORMAL MOVEMENT should be FREE !!
 - Steering with FAST MOVEMENT should be CONTROLLED BY DAMPER !!
- HYPHERPRO uses a special seal to reduce friction. The seal uses an oil film to work properly. It is normal that some oil can appear on the pistonrod.
- Damper works with oil: DAMPING CAN BE HARDER AT LOWER TEMPERATURES!

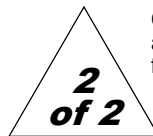

Step 1: installing the tank bracket

Install the tank bracket using:

- 2x Long nut M6 (1)
- Tank bracket (2)
- 2x Washer M6 Ø 12 (3)
- 2x Bolt M6x16 (4)
- Washer M8 Ø 16 (5)
- O-ring (6)
- Damper clamp Type1 (7)
- Bolt M8x25 Button head (8)

Remove the two original allen bolts from the ignition cover. Replace them with the Long M6 nuts (1). Tighten the nuts with a torque of 5-9Nm/44-88Lbs.In/4.0-6.4Lbs.Ft.

Install the Tank bracket (2) on top of the nuts using the M6 washers (3) and M6x16 bolts (4). Tighten the bolts (4) with a torque of 5-9Nm/44-88Lbs.In/4.0-6.4Lbs.Ft.

Install the damper clamp (7) to the tank bracket (2) using the washer (5), O-ring (6) and the M8x25 bolt (8). Tighten the bolt with a torque of approx. 14-17Nm/124-150Lbs.In/10.3-12.5Lbs.Ft

Step 2: installing the fork clamp

Install the fork clamp assembly using:

- Fork clamp Ø 53 (9)

Loosen the fork clamp bolts (9a) and shove the fork clamp (9) over the right fork leg, directly on top of the top yoke. Make sure the correct side is facing up, according to the pictures on page one. Align the angle of fork clamp to the yoke and tighten the clamp bolts (9a) with a torque of approx. 8Nm/70Lbs.In/5.9Lbs.Ft

Step 3: installing the steering damper

Install the steering damper using:

- Spacer Ø 14 d8.2 L20 (10)
- Washer M8 Ø 16 (11)
- O-ring (12)
- Steering damper S75 (13)
- Bolt M8x45 Button head (14)

Shove the damper (13), with the knob-end first, through the clamp (7) until the ball joint can be fitted to the fork clamp. Use the spacer (10), washer (11), O-ring (12) and M8 bolt (14) to fit the ball joint to the fork clamp and tighten with a torque of approx. 14-17Nm/124-150Lbs.In/10.3-12.5Lbs.Ft.

Position the damper tube until the distance "X" stated on page 1 is reached, then tighten the clamp-bolt (7a) with a torque of approx. 6Nm/53Lbs.In/4.4Lbs.Ft.

Check if the damper is level horizontally and aligned to the bike. Check if the damper does not touch anything (e.g. tank) when steering from left to right. Check if the bike can make it's full steering angle from left to right. Adjust distance X or fork clamp position if necessary to improve.

See WWW.HYPHERPRO.COM for the latest pictures, modifications, specs. and e-drawings of this steering damper kit.