

HYPHERPRO

STEERING DAMPER MOUNTING KIT

for

BUELL X1 Lightning Models 1999 ->

MK-BU12-S003 PART LIST

SD stroke 120	1	M8x35 Button head	1
Tube Clamp TYPE 2	1	Washer M8 ϕ 16	1
O-Ring	1	-	-
Fork Clamp ϕ 54	1	-	-
Frame Clamp Pt.1	1	-	-
Frame Clamp Pt.2	1	-	-
Spacer TYPE 1	1	-	-
M8x20	1	-	-

ALL IDEAS, DESIGNS ARRANGEMENTS AND PLANS INDICATED OR REPRESENTED BY THIS DRAWING ARE OWNED BY HYPERPRO AND WERE CREATED, EVOLVED AND DEVELOPED FOR USE ON AND IN CONNECTION WITH THE SPECIFIC PROJECT. NONE SUCH IDEAS, DESIGNS, ARRANGEMENTS OR PLANS SHALL BE USED BY OR DISCLOSED TO ANY PERSON, FIRM OR CORPORATION FOR ANY PURPOSE WHATSOEVER WITHOUT THE WRITTEN PERMISSION OF HYPERPRO.

DAMPING ADJUSTER KNOB:
 - turn CW to increase damping
 - turn CCW to decrease damping
 NEVER USE MAXIMUM SETTING !!!

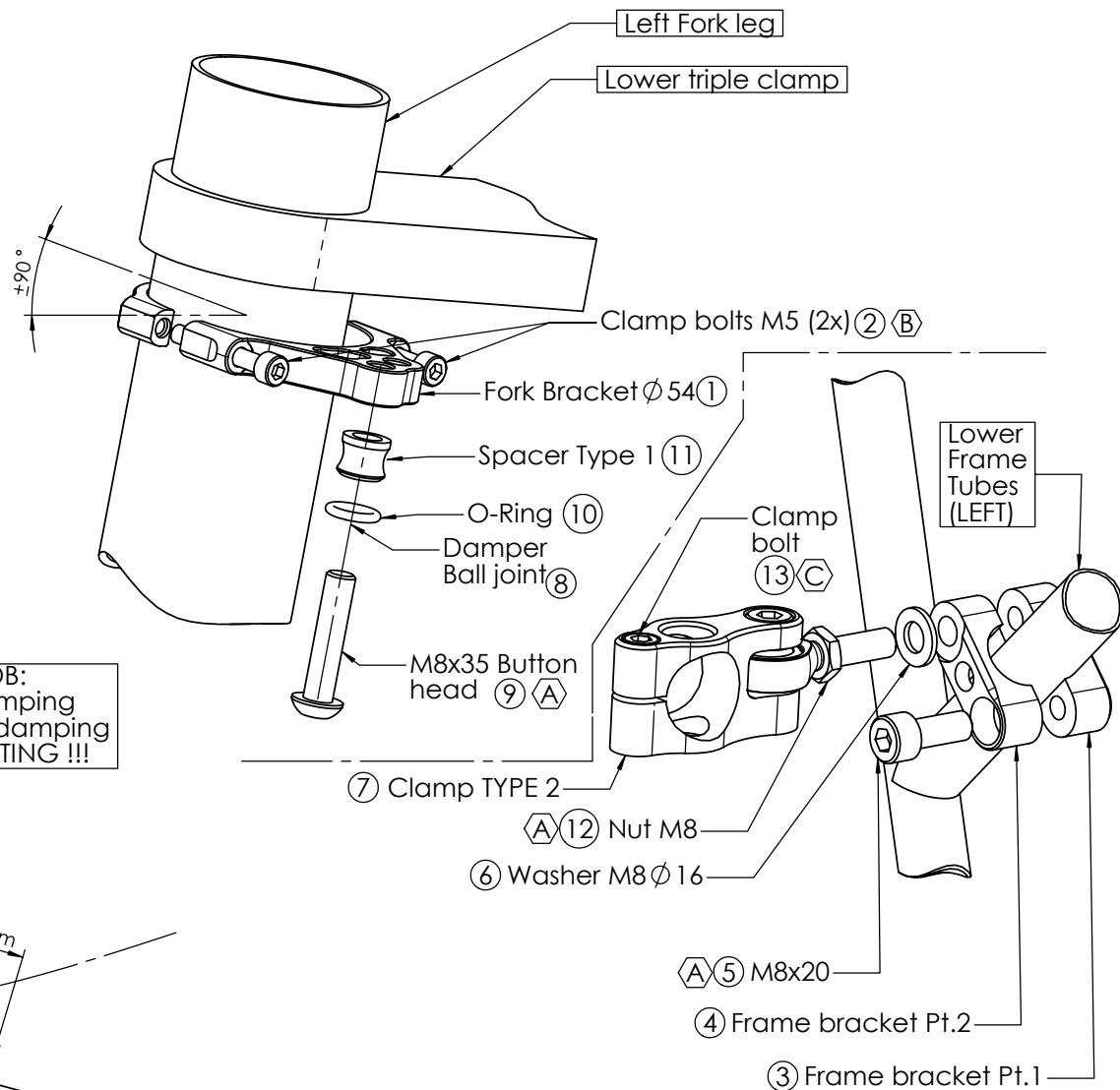
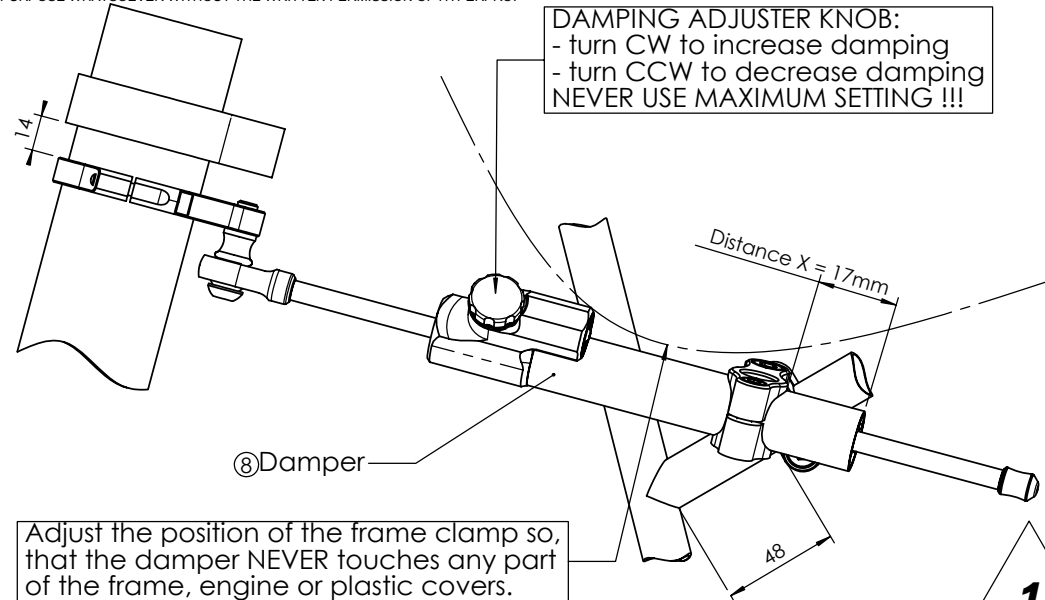

1
of 2

(A)	14-17Nm / 124-150Lbs.In / 10.3-12.5Lbs.Ft	(C)	6Nm / 53Lbs.In / 4.4Lbs.Ft
(B)	8Nm / 70Lbs.In / 5.9Lbs.Ft		

See WWW.HYPERPRO.COM for the latest pictures, modifications, specs. and e-drawings of this steering damper kit.

HYPERPRO

STEERING DAMPER MOUNTING KIT

for

BUELL X1 Lightning Model 1999 ->

MK-BU12-S003 INSTALLATION INSTRUCTIONS

In general:

HYPERPRO can not be held responsible in any way for any form of physical, material, financial or other damage arising from use, assembly or overhaul of HYPERPRO products. HYPERPRO reserves the right to make changes without prior notice.

This product is ONLY TO BE INSTALLED BY A PROFESSIONAL MECHANIC.

This product is only to be used for the motorcycle brand, model and year stated specifically on top of the pages of this manual.

DO NOT attempt to install this product on motorcycles from any different brand, model and/or year than stated on the pages of this manual.

DO NOT use this kit for cars, boats, jet-skies, snowmobiles, ATV's, aircraft, hovercrafts or any other vehical and/or purpose.

HYPERPRO steering dampers are FOR RACE USE ONLY, NOT FOR HIGHWAY USE!

Before installation:

- Please read the entire manual carefully before starting the installation!
- Check if you have all the tools required. Good tools are a must.
- Protect your bike at the most important places in and around the work area (e.g. tank, fairing, frame, etc.), with a blanket, towel or similar.

During installation:

- Check all operations and parts carefully before, during and after performing each step.
- Clean all surfaces that are required for fitting parts together or for applying self adhesives or loctite, thoroughly with contact cleaner or another degreaser, unless otherwise stated.
- Be careful not to damage or scratch any part of your bike.
- ALWAYS work relaxed and concentrated!! It is very easy to damage something or make a mistake.

After installation:

- Check and make sure that there is no contact between any part of the steering damper kit and any part of the motorcycle. The kit should not hit anything. Steering movement should not be limited by the steering damper. If the steering movement is limited, adjust the position of the tube in the clamp until steering movement is normal again. Do not forget to tighten the clamp bolt again!
- ALWAYS check the steering movement and feeling before each ride!
- FIRST RIDES: Start with the damper turned fully open (turn adjuster knob fully counter clockwise). Start adjusting in between rides with steps of MAX. 2 CLICKS (0.25 TURN) EACH TIME, until the damper is working satisfactory for your riding style.
- NEVER USE MAXIMUM SETTING, ALWAYS OPEN AT LEAST 2 CLICKS (0.25 TURN).

- WARNING ! DAMPER HAS AN ACTIVE / SPEEDSENSITIVE DAMPING SYSTEM;
 - Steering with NORMAL MOVEMENT should be FREE !!
 - Steering with FAST MOVEMENT should be CONTROLLED BY DAMPER !!
- HYPERPRO uses a special seal to reduce friction. The seal uses an oil film to work properly. It is normal that some oil can appear on the pistonrod.
- Damper works with oil: DAMPING CAN BE HARDER AT LOWER TEMPERATURES!

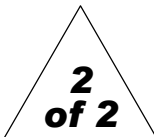

Step 1: installing the fork bracket

- Fork bracket \varnothing 54 (1)

Remove the 2 M5 clamp bolts (2) from the bracket (1). Place the bracket parts around the left fork leg, about 14mm below the lower triple clamp. Make sure that the holes are pointing backwards and that the hole with the greatest heart-to-heart distance is on the left side. Replace the clamp bolts and tighten them with a torque of approx. 8Nm/70Lbs.In/5.9Lbs.Ft

Step 2: installing the frame clamp & tube clamp

- Frame clamp Pt.1 (3)
- Frame clamp Pt.2 (4)
- Bolt M8x20 (5)
- Washer M8 \varnothing 16 (6)
- Tube Clamp TYPE 2 (7)

Place the frame clamp parts (3+4) around the left lower frame tube as shown on page 1. Bolt the parts lightly together with the M8x20 bolt (5) in the countersunk hole, then screw in the TYPE 2 clamp (7) (nut (12) screwed on as far as possible) with the washer (6) as far as possible. DO NOT FULLY TIGHTEN YET.

Step 3: installing the steering damper

- Steering damper (8)
- Bolt M8x35 button head (9)
- 1x O-ring (10)
- Spacer TYPE 1 (11)

Ensure that the clamp bolt of the tube clamp is pointing up. Shove the damper (8), with the knob-side first, from the front side through the clamp until the ball joint can be fitted to the fork bracket (1). Use the spacer (11), O-ring (10) and M8 bolt (9) to fixate the balljoint to the outer hole of the fork bracket and tighten with a torque of approx. 14-17Nm/124-150Lbs.In/10.3-12.5Lbs.Ft. Position the damper tube until the distance "X" (=17mm) stated on page 1 is reached, then tighten the M6 clamp bolt (13) with a torque of approx. 6Nm/53Lbs.In/4.4Lbs.Ft. Adjust the position of the frame clamp until the distance of 48mm is reached. Adjust the angle, until the damper CAN NOT hit any part of the frame, engine or plastic cap. Finally tighten the M8x20 bolt (5) and the Nut M8 (12) with a torque of approx. 14-17Nm/124-150Lbs.In/10.3-12.5Lbs.Ft.

Check if the damper is level horizontally and aligned to the bike. Check again if the damper does not touch anything (e.g. frame, engine or plastic covers) when steering from left to right. Check if the bike can make it's full steering angle from left to right.

See WWW.HYPERPRO.COM for the latest pictures, modifications, specs. and e-drawings of this steering damper kit.