

# HYPERPRO

## LOWERING KIT / VERLAGINGSSET for KAWASAKI KLV 1000 Models '04>

### LK-KA10-002-50 PART LIST

PR121580 - Pull rod/ trekstang	2
SL144710 - Stroke limiter/ slagbeperker	1
SL254707 - Stroke limiter/ slagbeperker	1
-	-

ALL IDEAS, DESIGNS, ARRANGEMENTS AND PLANS INDICATED OR REPRESENTED BY THIS DRAWING ARE OWNED BY HYPERPRO AND WERE CREATED, EVOLVED AND DEVELOPED FOR USE ON AND IN CONNECTION WITH THE SPECIFIC PROJECT. NONE SUCH IDEAS, DESIGNS, ARRANGEMENTS OR PLANS SHALL BE USED BY OR DISCLOSED TO ANY PERSON, FIRM OR CORPORATION FOR ANY PURPOSE WHATSOEVER WITHOUT THE WRITTEN PERMISSION OF HYPERPRO.

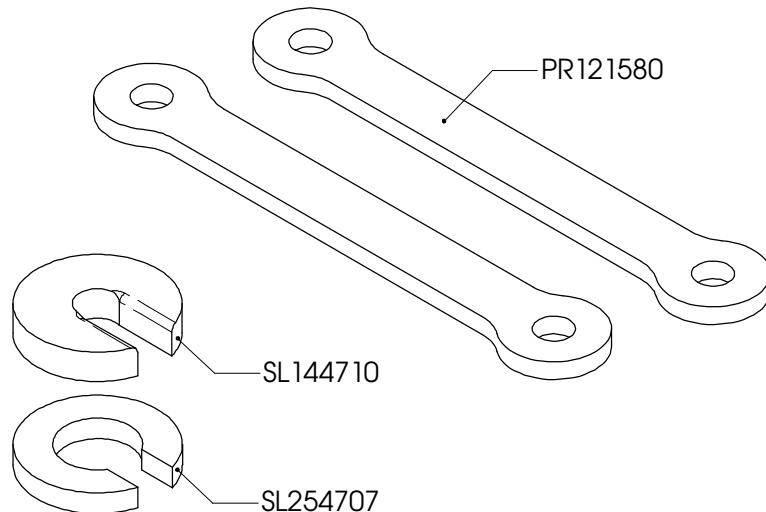

### Inbouw handleiding

#### VOORZIJD

De vorkpoten maximaal 27 mm door de bovenste kroonplaat heen steken.

#### ACHTERZIJD

De bestaande trekstangen vervangen door de HYPERPRO verlagings trekstangen.  
De slagbeperkers onder het aanslagrubber op de schokbreker plaatsen.  
Het achterwiel eerst belasten voordat de link vastgezet word.

LET OP! DE LENGTE VAN DE ZIJSTANDAARD MOET 30-35mm INGEKORT WORDEN.  
AFTERMARKET SPATBORDEN KUNNEN NIET TOEGEPAST WORDEN.  
DE MIDDENBOK VERWIJDEREN.

### Instruction manual

#### FRONT

Mount the fork legs max 27mm through the triple clamp.

#### REAR

Replace the original pull rods with the HYPERPRO lowering pull rods.  
Place the stroke limiters under the bump rubber of the shock.  
Put some pressure on the rear wheel before tightening the link.

WARNING! SHORTEN THE SIDE-STAND 30-35mm.  
AFTERMARKET REAR MUDGUARDS CAN NO LONGER BE USED.  
REMOVE THE CENTER STAND.

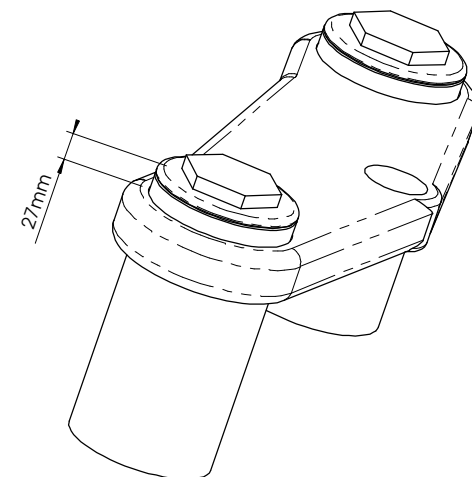

See [WWW.HYPERPRO.COM](http://WWW.HYPERPRO.COM) for more info about our products.