

HYPERPRO

LOWERING KIT / VERLAGINGSSET for KAWASAKI ZX6-R NINJA Models '95-'97

LK-KA06-001-40 PART LIST

PR121890 - Pull rods/ trekstangen	2
-	-
-	-
-	-

ALL IDEAS, DESIGNS, ARRANGEMENTS AND PLANS INDICATED OR REPRESENTED BY THIS DRAWING ARE OWNED BY HYPERPRO AND WERE CREATED, EVOLVED AND DEVELOPED FOR USE ON AND IN CONNECTION WITH THE SPECIFIC PROJECT. NONE SUCH IDEAS, DESIGNS, ARRANGEMENTS OR PLANS SHALL BE USED BY OR DISCLOSED TO ANY PERSON, FIRM OR CORPORATION FOR ANY PURPOSE WHATSOEVER WITHOUT THE WRITTEN PERMISSION OF HYPERPRO.

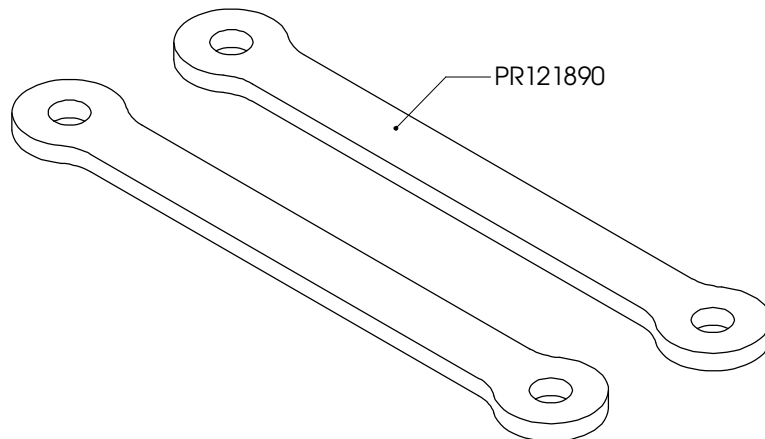

Inbouw handleiding

VOORZIJDJE

De vorkpoten maximaal 15mm door de bovenste kroonplaat heen steken. De veervoorspanning minimaal zetten (tegen de klok in draaien). De luchtkamer reduceren als de vork wil doorslaan.

ACHTERZIJDJE

De bestaande link vervangen door de HYPERPRO verlagingslink. Het achterwiel eerst belasten voordat de link vastgezet wordt. De veervoorspanning met 7mm verminderen.

LET OP! DE LENGTE VAN DE ZIJSTANDAARD MOET 25-30mm INGEKORT WORDEN. AFTERMARKET ACHTERSPEATBORDEN KUNNEN NIET MEER WORDEN TOEGEPAST.

Instruction manual

FRONT

Mount the fork legs max 15mm through the triple clamp. Turn the preload adjuster to minimum preload (counter clockwise). Reduce the air chamber if the fork hits the end of its stroke.

REAR

Replace the original link by the HYPERPRO lowering link. Put some pressure on the rear wheel before tightening the link. Reduce the spring preload with 7mm.

WARNING! SHORTEN THE SIDE-STAND 25-30mm. AFTERMARKET REAR MUTGARDS CAN NO LONGER BE USED.

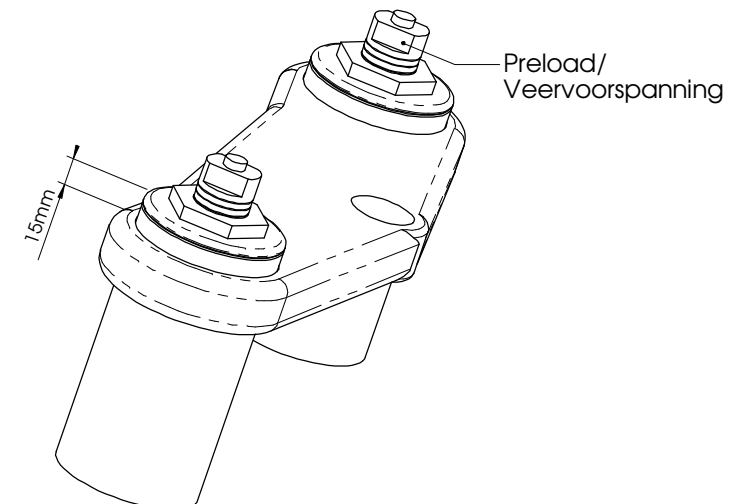

See WWW.HYPERPRO.COM for more info about our products.